



State Road (SR) 9/I-95 Northbound and Southbound Off-Ramps at Gatlin Boulevard Roadway Improvements Project

in St. Lucie County

Financial Project ID: 439761-1-52-01

Virtual Public Meeting
Wednesday, May 25, 2022

Virtual Public Meeting Orientation

Moderator & Presenter



Samantha Kayser
Community Outreach Specialist
The Corradino Group

Meeting Format

Presentation, Q&A Session

- 5 p.m. to 5:30 p.m.
- 5:30 p.m. to 6 p.m.

Unguided PowerPoint Slide Show

- If time allows

The Florida Department of Transportation is required to comply with various non-discrimination laws and regulations, including **Title VI of the Civil Rights Act of 1964.**

Public participation is solicited without regard to race, color, national origin, age, sex, religion, disability, or family status.

Persons wishing to express concerns about Title VI may do so by contacting either:

District Four

Florida Department of Transportation
District Four Title VI Coordinator

Sharon Singh Hagyan

(954) 777-4190,

Sharon.SinghHagyan@dot.state.fl.us



Tallahassee Office

Florida Department of Transportation
State Title VI Coordinator

Jacqueline Paramore

(850) 414-4753,

jacqueline.paramore@dot.state.fl.us



All inquiries or concerns will be handled according to FDOT procedure and in a prompt and courteous manner.

Virtual Public Meeting Orientation



- This Virtual Public Meeting is being recorded.
- All attendees **will remain muted** throughout the meeting.
- If you experience technical difficulties, please contact **GoToWebinar Support at +1(833) 851-8340.**
- At the end of the presentation attendees are also welcome to submit any questions/comments using the GoToWebinar Question Panel and a member of the team will respond during the question-and-answer portion. To request to speak, click the Raise Hand button on the Control Panel and unmute your microphone when your name is called.

Participating on GoTo Webinar

- If you would like to ask a question verbally, please click on the hand icon to be recognized.
- This meeting is being recorded and will be posted to www.d4fdot.com.

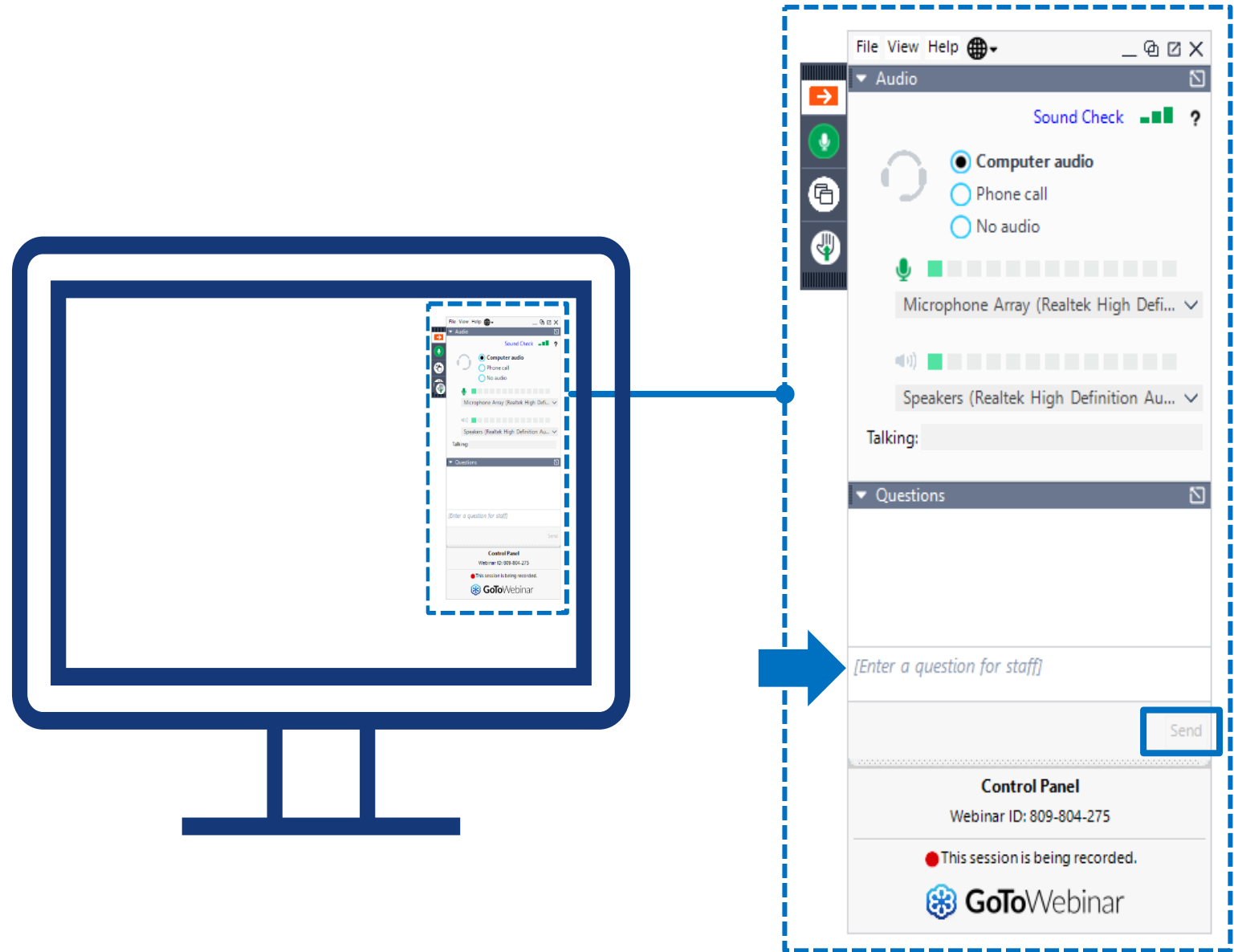

Meet the Team



Aaron Watt, P.E.
Construction Project Manager
FDOT District Four, Treasure Coast
Operations



Michael Jacobs
Construction Project Administrator
FDOT District Four, Treasure Coast
Operations



Brian Coblentz
Contractor
Halley Engineering Contractors, Inc.



Jeffrey Robbert, P.E.
Design Project Manager
FDOT District Four



Courtney Vaux Page, P.E.
Engineer of Record
Pevida Highway Designers, LLC



Heath Stocton, P.E.
Director of Public Works
City of Port St. Lucie

Project Presentation

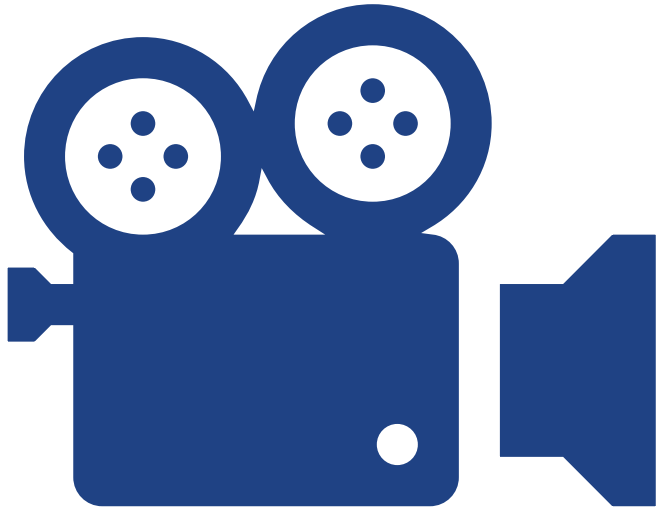

- Please enjoy the project video which includes information on the improvements to be completed, along with road and lane closure information.
- We will start the Question & Answer session after the video.

Project Limits

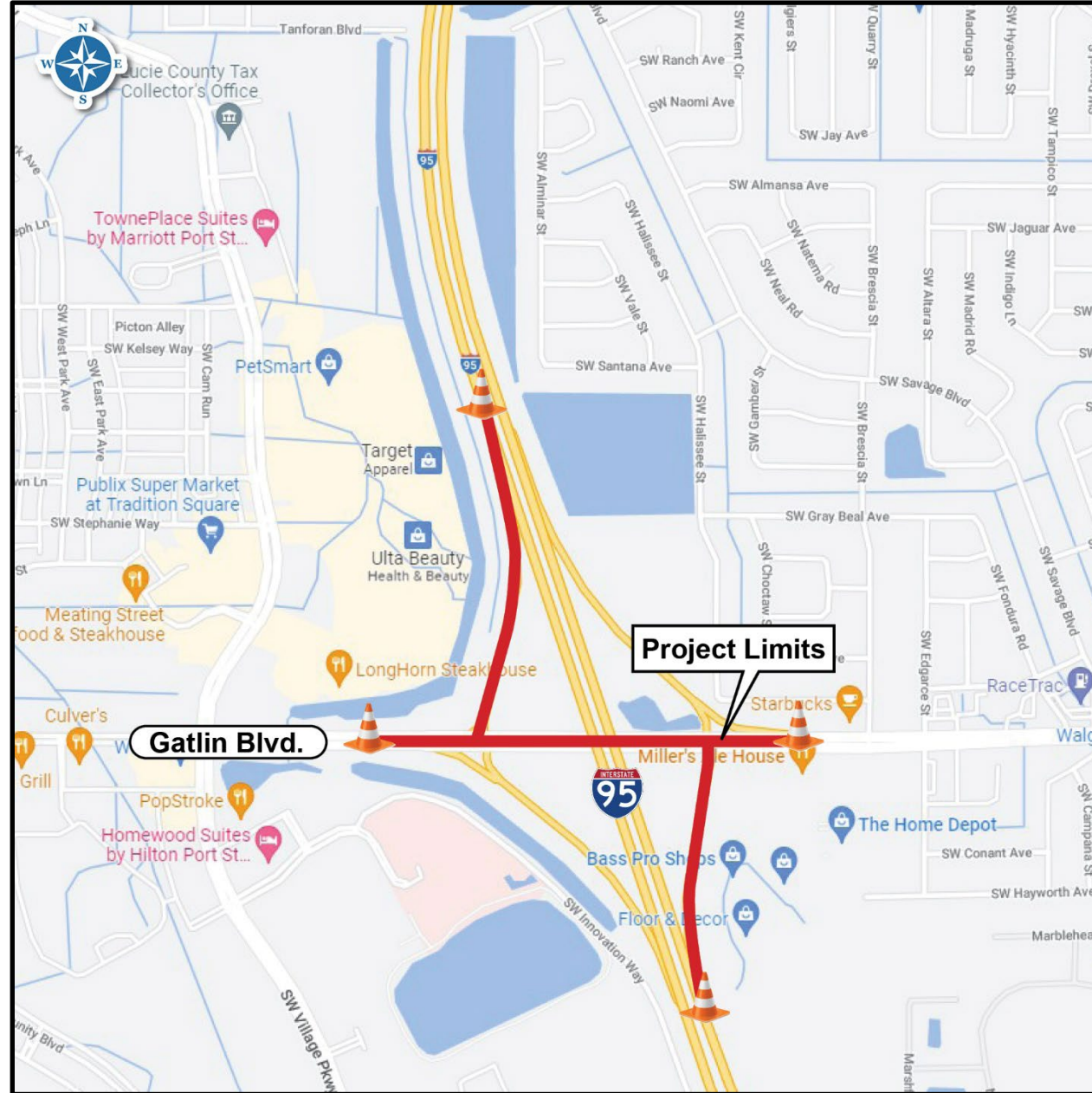

Project Overview

Purpose: Widen southbound I-95 to provide an auxiliary lane and shoulder; widen the I-95 southbound Gatlin Boulevard off-ramp; widen the inside of the I-95 northbound Gatlin Boulevard off-ramp to provide additional left turn lanes; widen eastbound and westbound Gatlin Boulevard; modify drainage, install new signage, and add new signing and pavement markings.

Length: 1.4 miles

Contractor: Halley Engineering Contractors, Inc.

Construction Start: June 10, 2022

Estimated Contract Cost: \$4.6 Million

Contract Time: 401 calendar days
(not including weather and holidays)

Estimated Completion: Fall 2023



Northbound I-95 off-ramp at Gatlin Boulevard
(pre-construction)

Roadway Improvements

- Widen southbound I-95 to provide a 12-foot auxiliary lane and a 12-foot shoulder (10-foot paved)
- Widen I-95 southbound Gatlin Boulevard off-ramp for the addition of a right-turn lane and a left-turn lane
- Widen the inside of the I-95 northbound Gatlin Boulevard off-ramp to provide three (3) left-turn lanes



Southbound I-95 off-ramp at Gatlin Boulevard
(pre-construction)



Roadway & Drainage Improvements

- Install one cantilever sign structure at the southbound I-95 off-ramp
- Add new signing and pavement markings
- Modify drainage to an open system with dry ponds



Southbound I-95 off-ramp at Gatlin Boulevard
(pre-construction)

Maintenance of Traffic

- Work will be done in four (4) major phases to minimize impacts to the construction corridor
- Work may take place Monday through Sunday
- Work will occur in one direction at a time on the eastbound and westbound approach of Gatlin Boulevard



Northbound I-95
(pre-construction)



Maintenance of Traffic

- Gatlin Boulevard lane closures are permitted as follows:
 - Single-lane closures are allowed at any time
 - Double-lane closures are allowed Sunday through Thursday night from 9:00 p.m. to 6:00 a.m.
- Pedestrian access will be maintained; should sidewalk closures be required, detours will be clearly marked



Northbound I-95 off-ramp at Gatlin Boulevard
(pre-construction)



I-95 Northbound & Southbound Off-Ramp Detour

Work on the northbound and southbound I-95 off-ramps at Gatlin Boulevard will require nighttime full closures. During this time, I-95 traffic will be detoured at Crosstown Parkway and Becker Road. Advance notice will be provided, and detour signage will be in place. Only one ramp will be closed at a time.

- **Northbound I-95 at Gatlin Boulevard Off-Ramp Closure:** Becker Road (Exit 114) to SW Port St. Lucie Boulevard to Gatlin Boulevard
- **Southbound I-95 at Gatlin Boulevard Off-Ramp Closure:** Crosstown Parkway (Exit 120) to Village Parkway Drive to Gatlin Boulevard

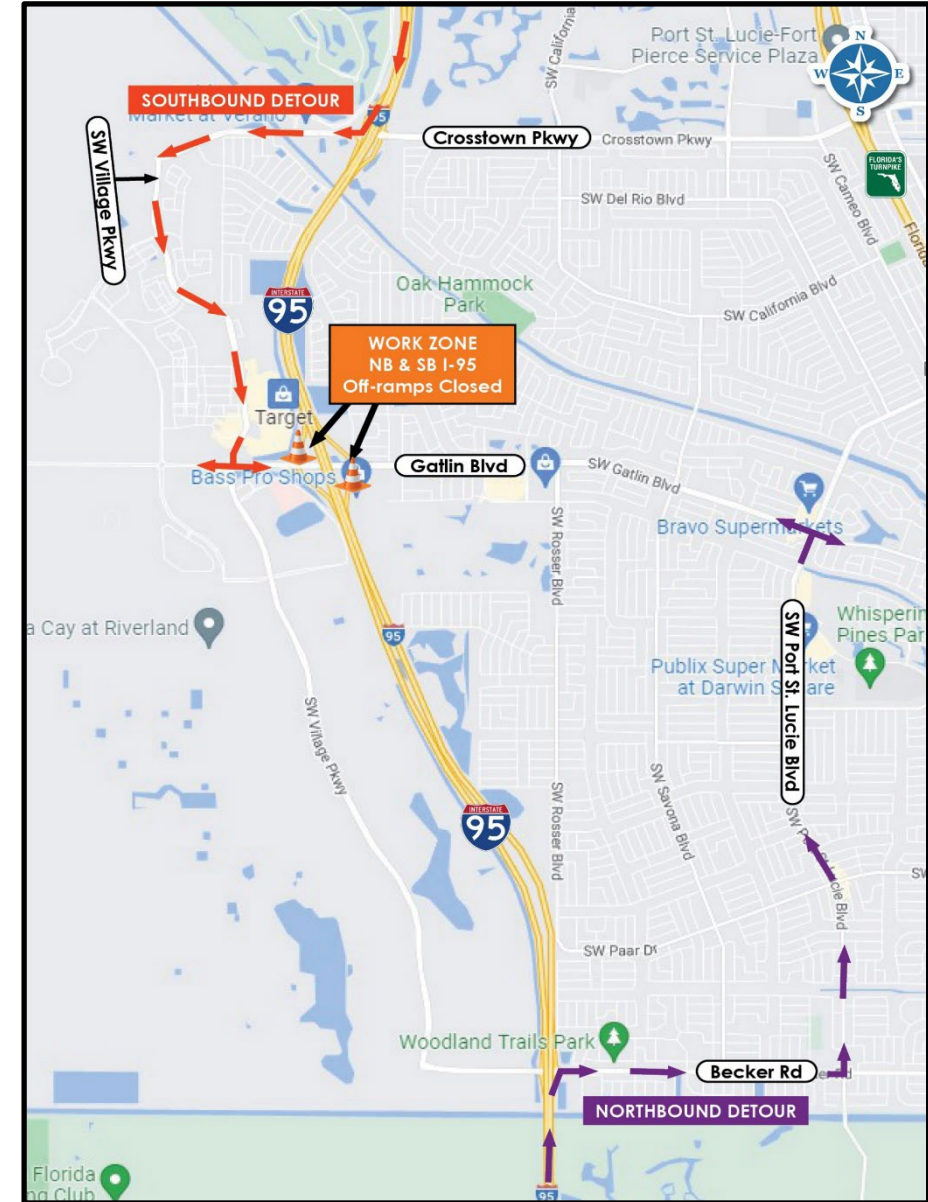

Project Overview

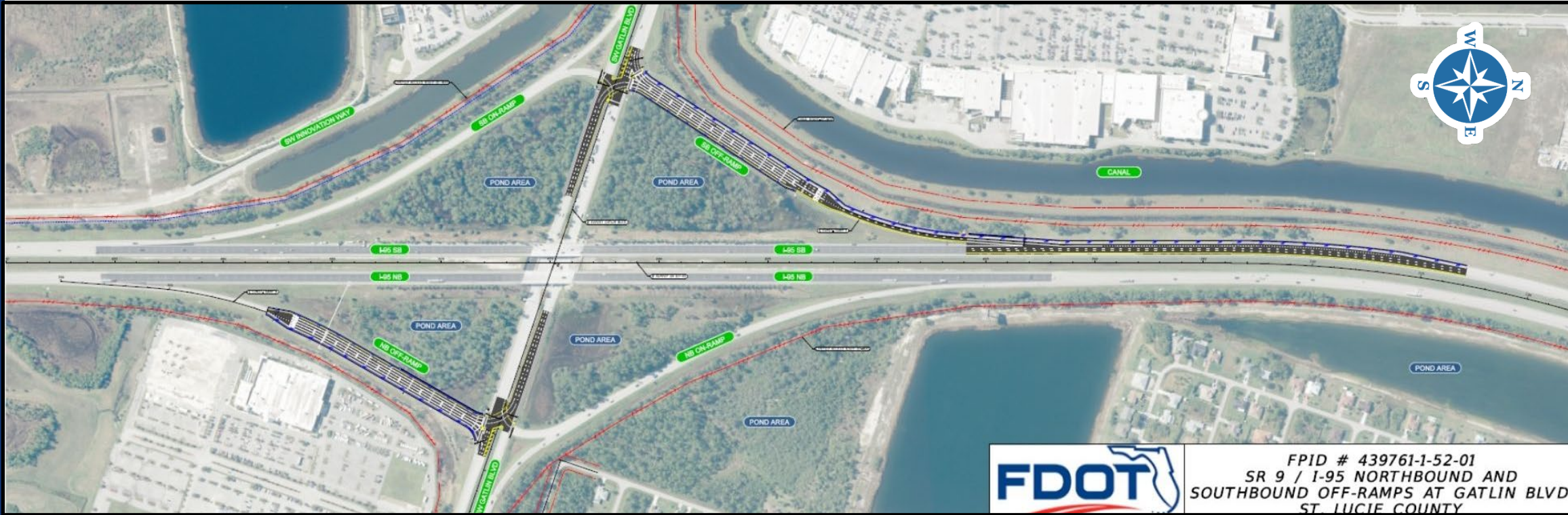



 FPID # 439761-1-52-01
 SR 9 / I-95 NORTHBOUND AND
 SOUTHBOUND OFF-RAMPS AT GATLIN BLVD
 ST. LUCIE COUNTY

This is a rendering of what the roadways will look like once the project is complete.

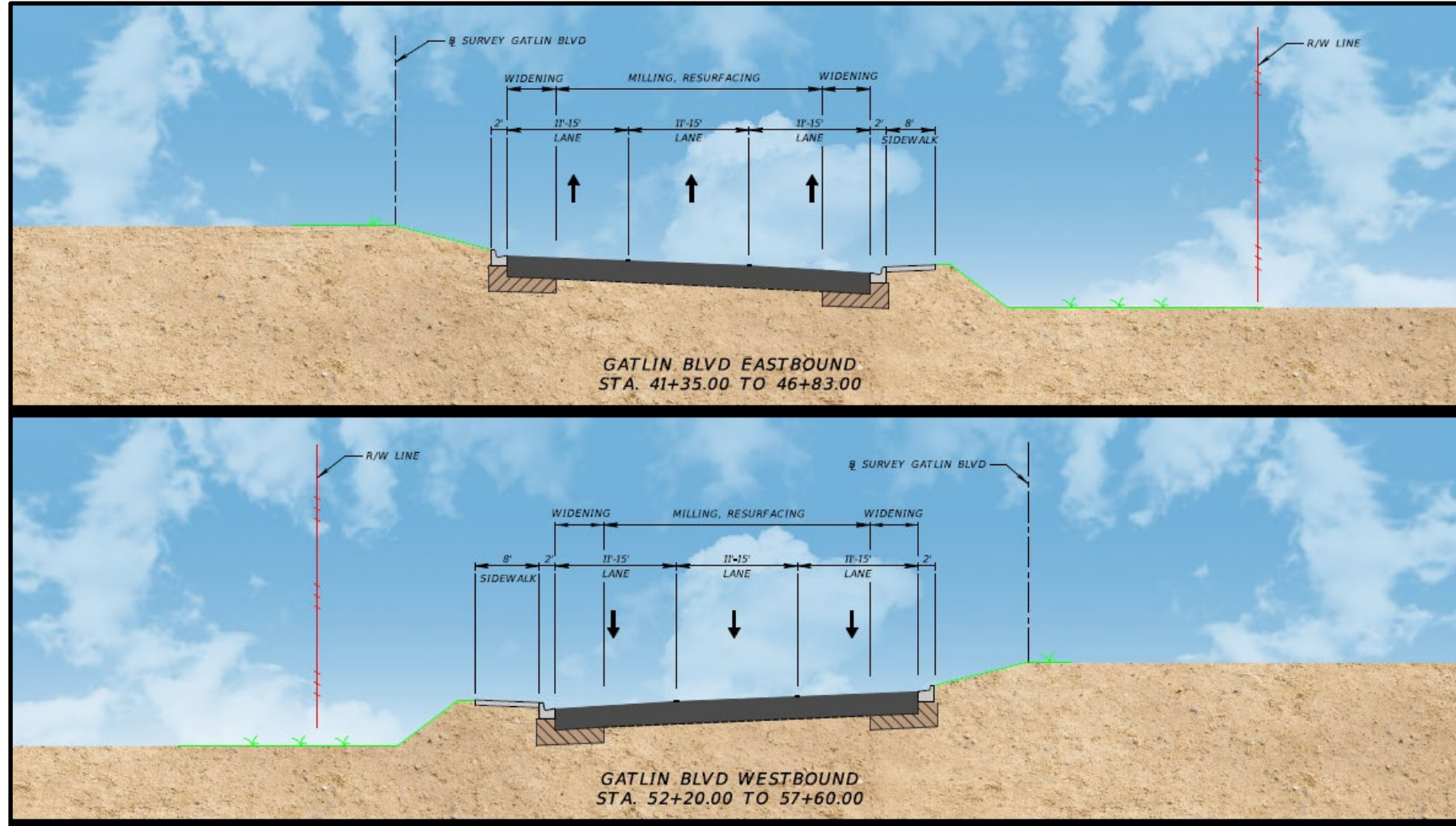

New Typical Section – Gatlin Boulevard



Top Image: The new typical section of what eastbound Gatlin Boulevard will look like once the project is complete.

Bottom Image: The new typical section of what westbound Gatlin Boulevard will look like once the project is complete.

New Typical Section – I-95 Southbound Off-Ramp at Gatlin Boulevard

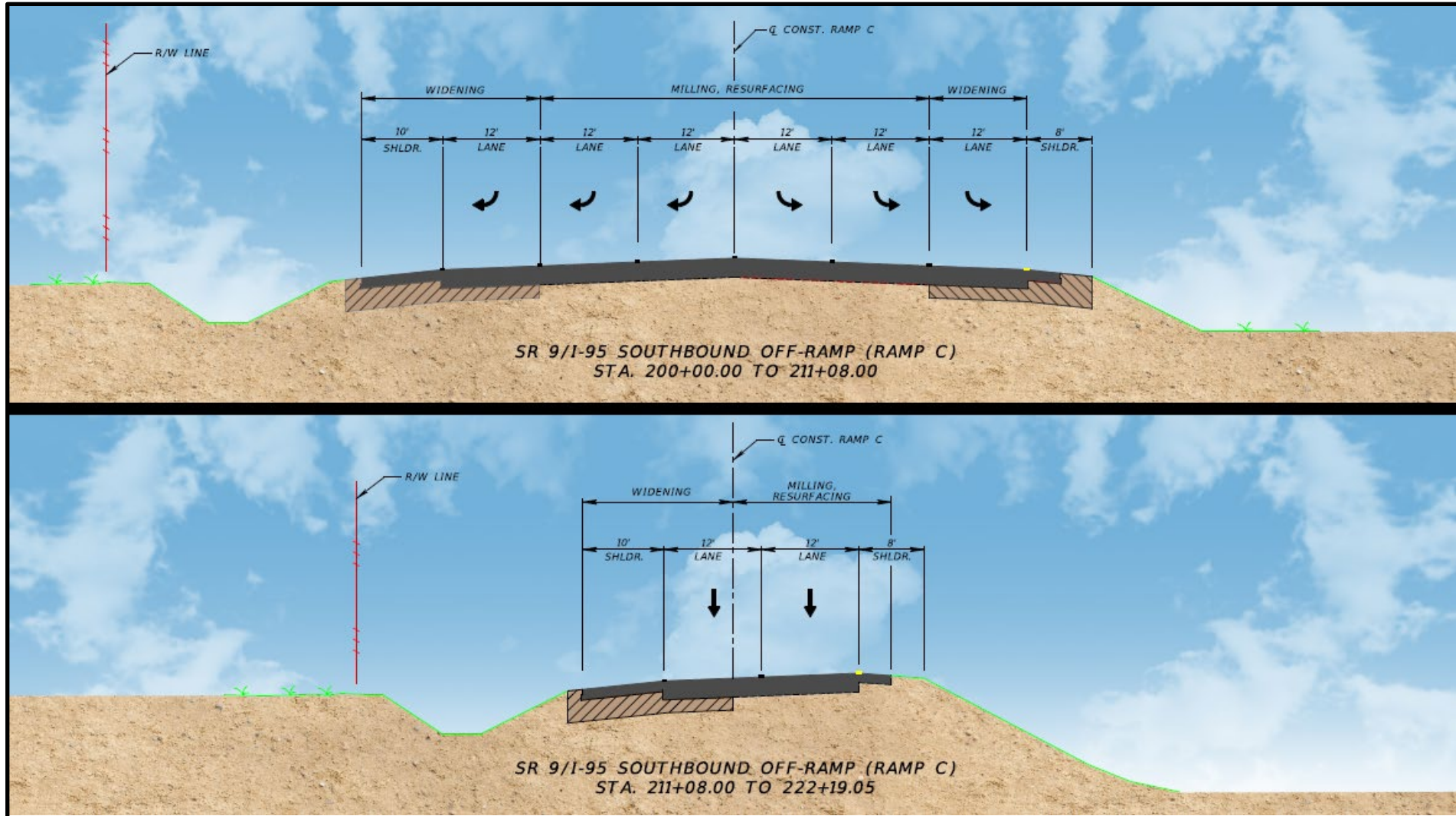

Bottom Image: The bottom image shows the new typical section of the widening of the auxiliary lane upon entering the off-ramp once the project is complete.

Top Image: The top image shows the new typical section of what the southbound I-95 off-ramp at the Gatlin Boulevard intersection will look like once the project is complete.

New Typical Section – I-95 Southbound

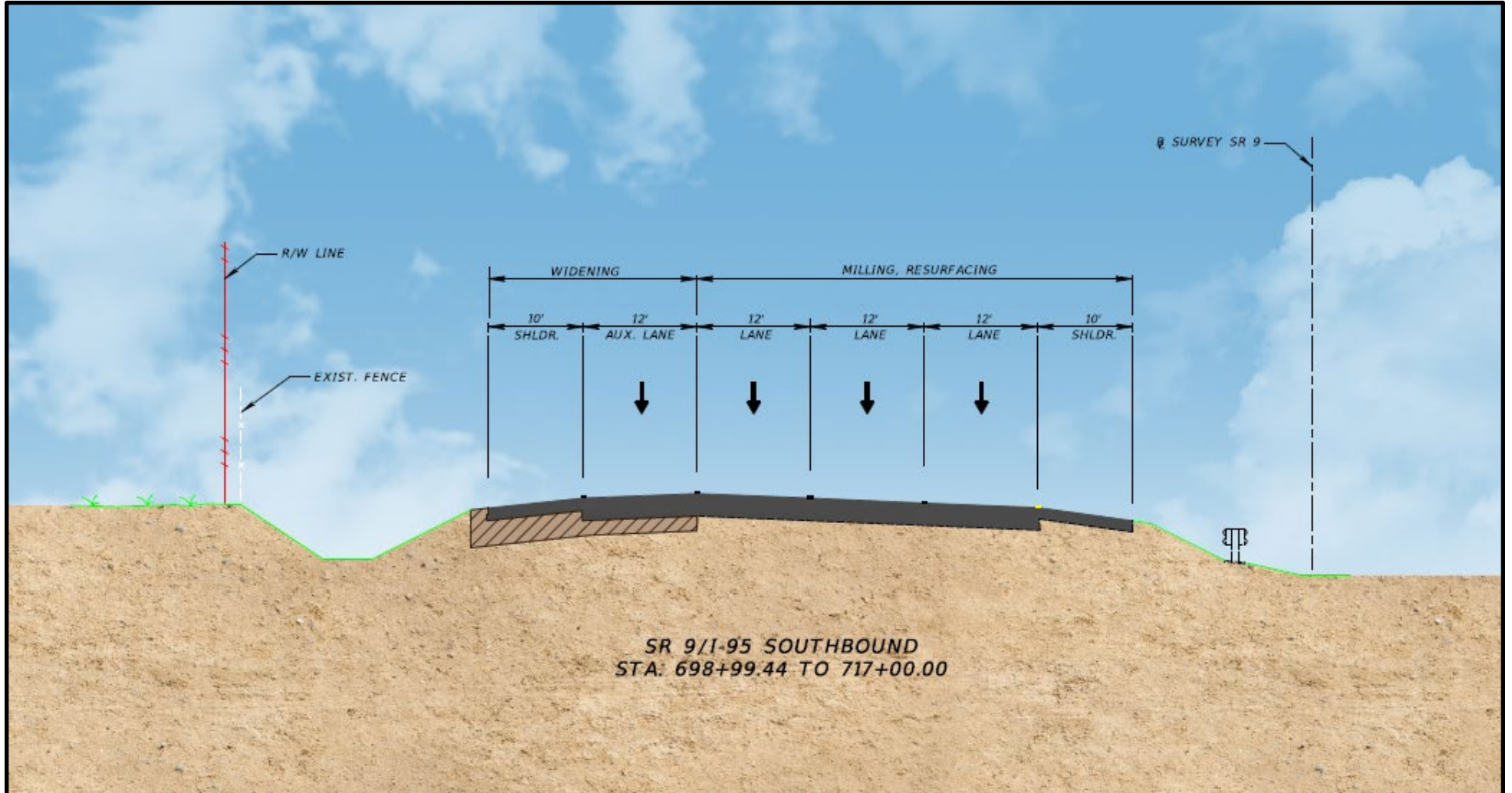

This image shows the new typical section of what I-95 southbound will look like once the project is complete.



New Typical Section – I-95 Northbound Off-Ramp at Gatlin Boulevard

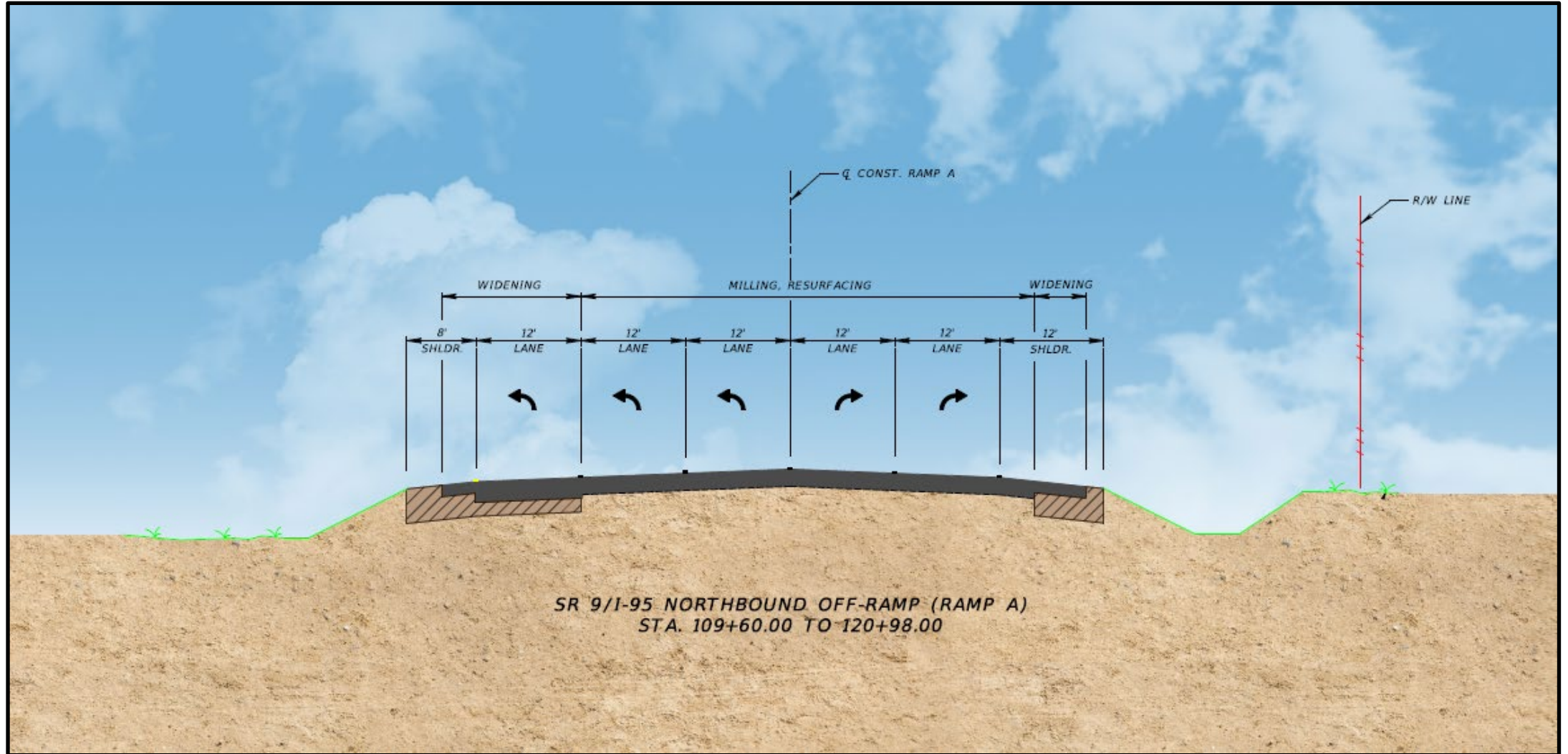

This image shows what the new typical section of the northbound I-95 off-ramp at Gatlin Boulevard will look like once the project is complete.



Phase 1A

- I-95 Northbound Off-Ramp (Ramp A)

- Shift traffic to the outside and widen the inside of the I-95 northbound off-ramp
- Construct 8-foot shoulder (4-feet paved)
- Install guardrail and drainage

- Westbound Gatlin Boulevard

- Widen outside of westbound Gatlin Boulevard
- Install curb and gutter, and sidewalks
- Construct drainage inlets and install embankment
- Install lighting and signalization



Phase 1B

- I-95 Northbound Off-Ramp (Ramp A)

- Shift traffic to the inside
- Construct 12-foot shoulder (10-feet paved) along I-95 northbound off-ramp



- Westbound Gatlin Boulevard

- Widen inside lanes of westbound Gatlin Boulevard
- Construct median and curb and gutter along the inside of Gatlin Boulevard

Phase 2A

- **I-95 Southbound Off-Ramp (Ramp C)**
 - Shift traffic to the inside lanes
 - Widen southbound I-95 to the outside
 - Construct auxiliary lane and 12-foot shoulder (10-feet paved)
 - Build gravity wall with traffic railing along southbound I-95



Southbound I-95 off-ramp at Gatlin Boulevard
(pre-construction)



Phase 2A

- Eastbound Gatlin Boulevard

- Widen the outside lanes of eastbound Gatlin Boulevard
- Construct median and curb and gutter along the outside of Gatlin Boulevard
- Install lighting and signalization, gravity wall, drainage inlets, sidewalk, and embankment along the outside of Gatlin Boulevard



Gatlin Boulevard
(pre-construction)



Phase 2B



- **I-95 Southbound Off-Ramp (Ramp C)**

- Shift traffic to the inside
- Widen I-95 southbound single-lane off-ramp to the outside
- Construct auxiliary lane and 12-foot shoulder (10-feet paved)

- **Eastbound Gatlin Boulevard**

- Widen the inside lanes of eastbound Gatlin Boulevard
- Construct median and curb and gutter along the inside of Gatlin Boulevard



Phase 3A

- I-95 Southbound Off-Ramp (Ramp C)

- Shift traffic to the inside lanes
- Widen the I-95 southbound single-lane off-ramp to the outside
- Construct auxiliary lane and 12-foot shoulder (10-feet paved), embankment, and swale along outside lane of the ramp



Southbound I-95 off-ramp
(pre-construction)



Phase 3B

- I-95 Southbound Off-Ramp (Ramp C)

- Shift traffic to the outside
- Widen the I-95 southbound single-lane off-ramp to the inside
- Construct auxiliary lane, 12-foot shoulder (10-foot paved) and embankment



Southbound I-95 off-ramp at Gatlin Boulevard
(pre-construction)



Phase 4A

- I-95 Southbound Off-Ramp (Ramp C) & Gatlin Boulevard

- Mill and resurface the eastbound travel lanes and intersection at Gatlin Boulevard and the I-95 southbound off-ramp
- Install final pavement markings
- At least one lane of travel will be open to motorists in each direction at Gatlin Boulevard at all times



Phase 4B

– I-95 Northbound Off-Ramp (Ramp A) & Gatlin Boulevard

- Mill and resurface the westbound travel lanes and intersection at Gatlin Boulevard and the I-95 northbound off-ramp
- Install final pavement markings
- At least one lane of travel will be open to motorists in each direction at Gatlin Boulevard at all times



Northbound I-95 off-ramp at Gatlin Boulevard
(pre-construction)



Phase 4A & 4B

– I-95 Northbound and Southbound Off-Ramps (Ramp A and Ramp C)

- Mill and resurface the off-ramps
- Mill and resurface I-95 southbound mainline and inside shoulder
- Install final pavement markings
- Full off-ramp closures will occur with detours
- Only one ramp will be closed at a time



Northbound I-95 off-ramp at Gatlin Boulevard
(pre-construction)

Safety and Local Coordination



- **Public Safety is our Top Priority!**
 - **Work Zone Signage & Maintenance of Traffic**
 - Advanced warning and project signage will be placed throughout the construction corridor to alert the traveling public
 - **Local Agency & Stakeholder Coordination**
 - The project team will continue working closely with local stakeholders including local municipalities, schools, neighborhoods and other local agencies to ensure safety standards are met and impacts to the public are minimized in any way possible
 - **Emergency vehicles will be provided access at all times**



Lighted Message Board

Community Outreach

- To receive project specific updates please email skayser@corrado.com to be added to the distribution list
- A weekly press release will be distributed every Friday
- Additional project specific information can be found on the website

****All project updates will be posted to the District Four website.****



Scan this QR code to go to the District Four Website.

www.d4fdot.com



Questions and Answers

- Attendees are welcome to submit questions/comments using the GoToWebinar Question Panel

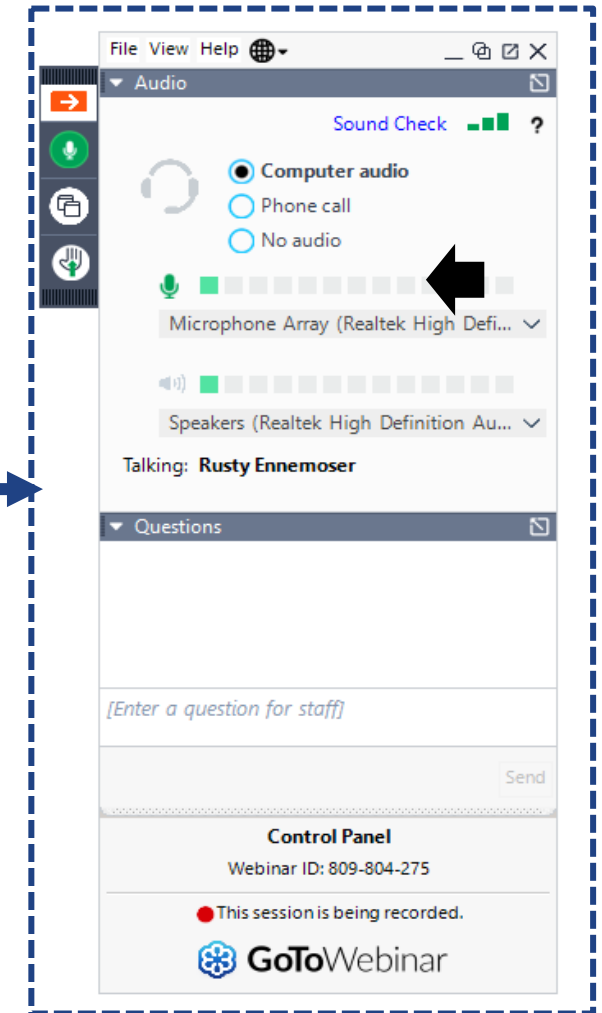

Contact Us

Throughout the project, questions or comments can be submitted via email or phone.

Samantha Kayser
Community Outreach Specialist



skayser@corradino.com



(772) 579-5479

Michael Jacobs
Construction Project Administrator



michael.jacobs@dot.state.fl.us



(772) 579-3276

Aaron Watt, P.E.
Construction Project Manager



aaron.watt@dot.state.fl.us



(772) 429-4938

*This PowerPoint presentation has been
uploaded to GoToWebinar for
download.*

FDOT Safety Message





**Thank you for attending today's
Virtual Public Meeting!**